



ORACLE LIGHTING

JL/JT LED SIDE MIRRORS
ORACLE PART #5855-001
INSTALLATION GUIDE

TOOLS NEEDED:
JEEP TOOL KIT (RATCHET & T40 BIT)
PHILLIPS & FLAT HEAD SCREWDRIVER
ELECTRICAL TAPE
PANEL TOOL
WIRING FISHING TOOL

STEP: 1

WATCH THE VIDEO
SCAN QR OR VISIT:



WWW.VIMEO.COM/725004129



REMOVE THESE (3) T-40 TORX BOLTS TO DISCONNECT FACTORY MIRRORS.



UNPLUG THE MIRROR FROM THE FACTORY HARNESS.



GIVE A FIRM TUG TO REMOVE THE MIRROR GLASS. UNPLUG THE HEATING ELEMENT WIRES AS WELL.



USE A PANEL TOOL TO SEPARATE THE BACK SHELL FROM THE MIRROR ASSEMBLY.



USE FLAT HEAD SCREWDRIVER TO UNPLUG THIS CLIP TO FREE UP SLACK IN THE FACTORY MIRROR HARNESS.

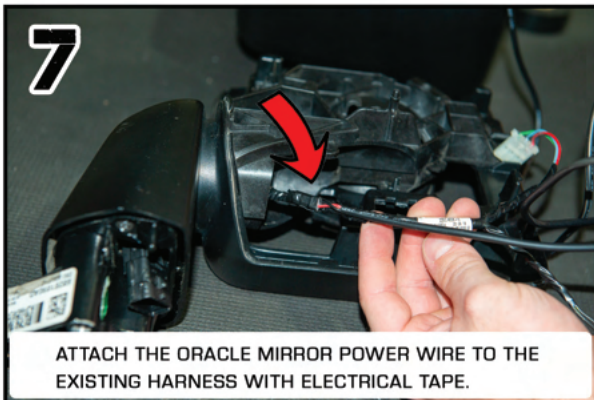

ATTACH THE ORACLE MIRROR POWER WIRE TO THE EXISTING HARNESS WITH ELECTRICAL TAPE.

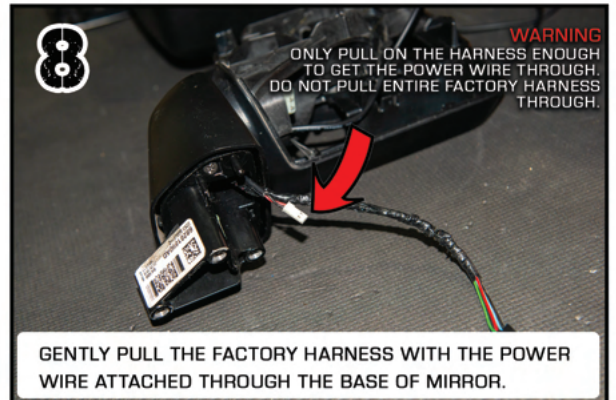

WARNING
ONLY PULL ON THE HARNESS ENOUGH TO GET THE POWER WIRE THROUGH. DO NOT PULL ENTIRE FACTORY HARNESS THROUGH.

GENTLY PULL THE FACTORY HARNESS WITH THE POWER WIRE ATTACHED THROUGH THE BASE OF MIRROR.



ORACLE LIGHTING

JL/JT LED SIDE MIRRORS

ORACLE PART #5855-001

INSTALLATION GUIDE

TOOLS NEEDED:
JEEP TOOL KIT (RATCHET & T40 BIT)
PHILIPS SCREWDRIVER
ELECTRICAL TAPE
PANEL TOOL
WIRING FISHING TOOL

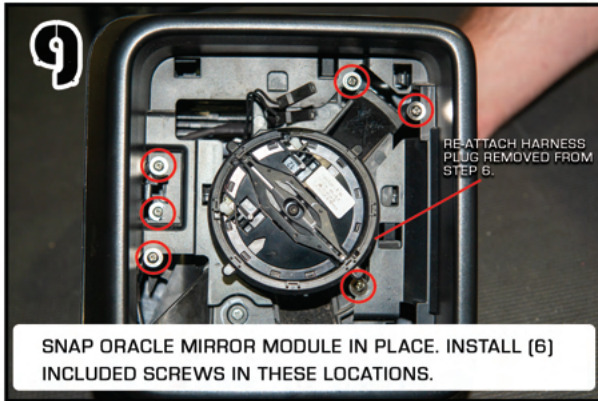

SNAP ORACLE MIRROR MODULE IN PLACE. INSTALL (6) INCLUDED SCREWS IN THESE LOCATIONS.



PLUG HEATING ELEMENT BACK IN. RE-INSTALL MIRROR GLASS.

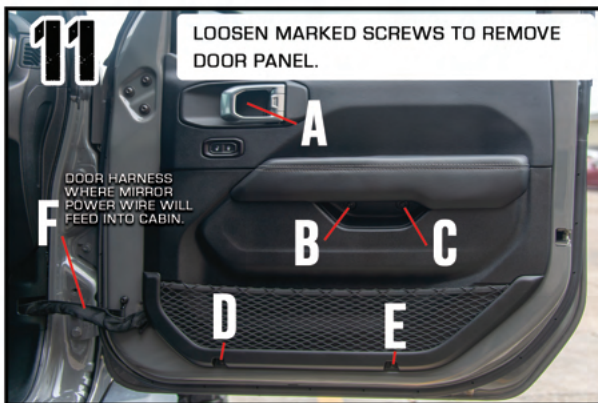

LOOSEN MARKED SCREWS TO REMOVE DOOR PANEL.



PULL FIRMLY TO REMOVE DOOR PANEL FROM DOOR.

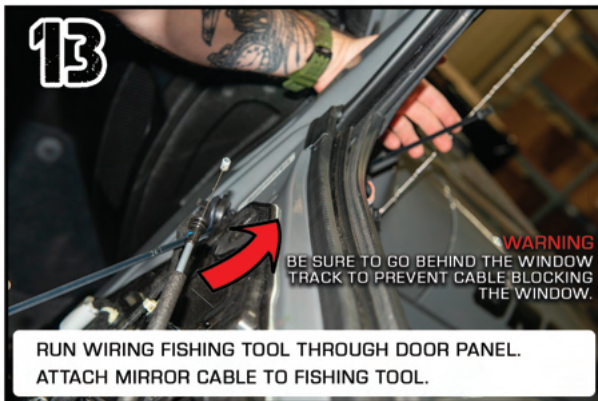

RUN WIRING FISHING TOOL THROUGH DOOR PANEL. ATTACH MIRROR CABLE TO FISHING TOOL.

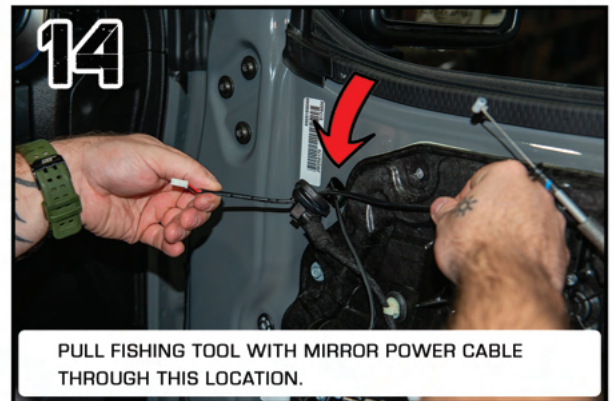

PULL FISHING TOOL WITH MIRROR POWER CABLE THROUGH THIS LOCATION.



RE-INSTALL MIRROR TO VEHICLE. RE-CONNECT HARNESS AND TIGHTEN DOWN (3) T-40 TORX BOLTS.



RUN FISHING TOOL THROUGH DOOR HARNESS

ATTACH MIRROR POWER CABLE

PULL FISHING TOOL BACK THROUGH WITH POWER CABLE

CONNECT TO AUX SWITCH